

**Kingsbridge Road  
 Morden, SM4 4PY**

**Offers In Excess Of £570,000 Freehold**



This desirable house situated on Kingsbridge Road in Morden, this charming three-bedroom house offers a perfect blend of comfort and potential. Spanning an impressive 797 square feet, the property features a welcoming reception room that invites relaxation and social gatherings. The well-appointed kitchen and dining area provide a functional space for family meals and entertaining guests.

The three spacious bedrooms are designed with built-in wardrobes, ensuring ample storage while maintaining a tidy aesthetic. The luxurious bathroom adds a touch of elegance, making it a delightful retreat for unwinding after a long day.

One of the standout features of this property is the expansive garden, which not only offers a serene outdoor space for children to play or for hosting summer barbecues but also includes an outhouse that can serve various purposes, from a home office to a creative studio. The potential to extend at the rear of the property (subject to planning) presents an exciting opportunity for those



## KINGSBRIDGE ROAD, SM4

Approx. Gross Internal Floor Area

1031 Sq. ft/95.82 Sq. m (Incl. Outbuildings)

797 Sq. ft/74.04 Sq. m (Excl. Outbuildings)

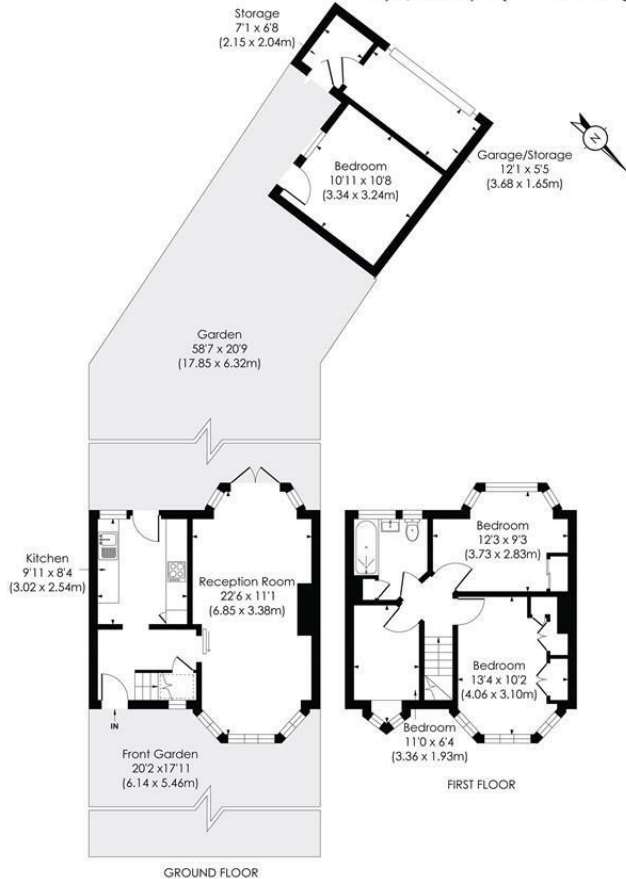

© Pixangle Property Marketing Ltd. info@pixangle.com Tel: 0208 870 2118

pixangle  
PROPERTY MARKETING

This floor plan has been prepared for the purpose of illustration only in accordance with the latest RICS code of measuring practice and is not to scale. All measurements and areas are approximate and whilst every effort has been made to ensure the accuracy of the plan contained here, no responsibility is taken for any error, omission or misstatement.

- 'Tudor Style' Terraced Family Home
- Three Bedrooms Plus Fourth Bedroom in Converted Garage
- Open-Plan Reception
- 58ft South-West Facing Garden
- Potential to Extend (STPP)
- Desirable Location in Lower Morden
- Close to Sought After Schools & Transport Links
- Freehold
- EPC Rating - D
- Merton Council Tax Band - D

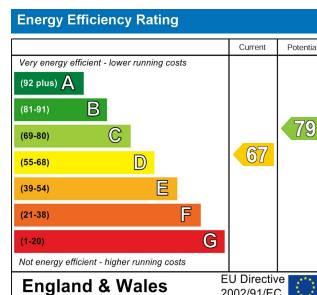

For Free Mortgage Quote and Best Mortgage Rates, call Ellisons Mortgage Advisor on 0208 543 1166



Although these particulars are believed to be correct, their accuracy is not guaranteed and they do not form part of any contract.

Celebrating 30 years  
of successful Sales and  
Lettings in Merton

